



# Master Power® Industrial Power Tools

 **COOPER** PowerTools



Cooper Power Tools Division has attained ISO 9001 Quality System Certification for seven of our facilities. The driving force behind the implementation of the Quality System is the commitment “to provide our customers with the **best value delivered** by offering only products and services **that meet or exceed their expectations**”.



Lexington, South Carolina



Dayton, Ohio



Hicksville, Ohio



Springfield, Ohio



Braunschweig, Germany



Westhausen, Germany



Ozoir-la-Ferrière, France

# Model Number Index

Model Number	Page	Model Number	Page	Model Number	Page	Model Number	Page
5171	40	710009	17	70422100	11,12	MP4200	35
5173	43	710011	17	70444800	11	MP4201	35
14502	43	710012	17	70488400	43	MP4400-03	11
22034	15	710013	17	70493600	12	MP4400-05	11
51653	46	710014	17	70494300	12	MP4400-06	11
51654	46	710015	17	70497600	43	MP4400-15	11
51656	46	710016	17	70497700	43	MP4400-23	11
51657	46	710017	17	70497800	43	MP4400-25	11
51700	40	710018	17	70497900	43	MP4400-35	11
51710	40	710025	17	70498000	43	MP4403-05	11
51712	40	710026	17	70498100	43	MP4403-06	11
51713	40	710027	17	70498200	43	MP4403-15	11
51714	40	710028	17	70498300	43	MP4403-35HL	12
51737	40	710030	17	70498400	43	MP4424	36
51738	40	710031	17	70498600	43	MP4425	15
51741	40	710032	17	70505200	13	MP4430	36
51742	40	710033	17	80046800	43	MP4452	37
51743	40	710034	17	80110000	43	MP4458	36
51744	40	710040	17	80110100	43	MP4470-09	12
51745	40	710041	17	80170500	15	MP4472	37
51746	40	710043	17	88004400	11	MP4542	37
51747	40	710044	17	90013500	43	MP4552	37
51748	40	710045	17	100704300	11,12	MP4553	37
51749	40	710051	17	MP1000F-1	14	MP5161	41
57435	15	718479	40	MP1000F-6	14	MP5164	41
57436	15	718480	40	MP1000F-7	14	MP5168	41
60538	43	718481	40	MP1454-38	20	MP5173	39
60539	43	718482	40	MP1457-51	20	MP5174	39
63593	15	770501	43	MP1458-55	21	MP5187	39
63594	43	800493	15	MP1463-51	21	MP5195	40
63596	43	800992	17	MP2264	30	MP600-5	14
479401	43	2028500	15	MP2265	30	MP6151	15
513156	43	5861600	45	MP2266	30	MP8000	16
540395	43	8013100	46	MP2271	31	MP8001	16
543011	13	8620800	28	MP2276	31	MP8002	16
543012	13	9111500	28	MP2294	32	URM1041	14
543013	13	9112301	43	MP2295	32	URM1049-B	14
543014	13	9253500	41,42	MP2422	28	URM1050-3	14
543017	13	9253600	42	MP2426	28	URM1053	14
543018	13	9253900	41,42	MP2433	29	URM1108	14
543019	13	9254000	41,42	MP2436	29	URM2119	14
543020	13	9254200	42	MP2437	29	URM2131	14
543021	13	9254300	42	MP2452	26	URM2166-2	14
543022	13	9254500	41,42	MP2453	26	URM700	14
543023	13	9254600	41,42	MP2454	26		
543024	13	70194901	43	MP2464	27		
543025	13	70414700	28	MP2465	27		
543025	13	70414800	28	MP2465SR	27		
543026	13	70414900	28	MP2466	27		
543041	13	70420000	12	MP2474	28		
543042	13	70420100	12	MP2476	28		
543944	43	70420500	12	MP2477	28		
613301	43	70421900	11,12	MP2478	28		
710006	17	70422000	11,12	MP4000F-6	14		



<b>Model Number Index</b> .....	<b>3</b>
<b>Master Power Features</b> .....	<b>4-5</b>
<b>Tool Warranty &amp; Operation</b> .....	<b>6-7</b>
<b>Finishing Tools</b> .....	<b>8-17</b>
Features .....	8-9
Random Orbital & Orbital Sanders .....	10-13
Sanders/Polishers .....	14
Angle & Disc Sanders .....	15
Vacuums .....	16-17
<b>Drills</b> .....	<b>18-21</b>
Features .....	18-19
Pistol Grip .....	20-21
<b>Fastening Tools</b> .....	<b>22-37</b>
Features .....	22-25
Pistol Grip Screwdrivers – Direct Drive .....	26
Pistol Grip Screwdrivers – Positive Clutch .....	27
Pistol Grip & Inline Screwdrivers – Adjustable Clutch .....	28
Pistol Grip & Inline Screwdrivers – Versa Clutch .....	29
Impact Wrenches .....	30-32
<b>Grinding Tools</b> .....	<b>34-37</b>
Features .....	34
Pencil Grinders .....	35
Die Grinders .....	36-37
Wheel Grinders .....	37
<b>Cutting &amp; Percussion Tools</b> .....	<b>38-42</b>
Scaling Hammers & Needle Scalers .....	39-40
Power Chisel .....	41
Accessories .....	42
<b>Tool Accessories</b> .....	<b>43</b>
<b>Training</b> .....	<b>44-45</b>
<b>Conversion Tables</b> .....	<b>46-47</b>
<b>Sales &amp; Service Centers</b> .....	<b>48</b>
<b>Cooper Power Tools on the Web</b> .....	<b>IBC</b>

**FINISHING**

**DRILLS**

**FASTENING**

**GRINDERS**

**CUTTING & PERCUSSION**

**ACCESSORIES**



# Great new tools for 2008. Same great value since 1939.



Since our founding in 1939, Master Power has been producing quality air tools for a complete range of industrial applications.

For 2008, that tradition of quality continues.

Some examples of our new line are shown on

the pages that follow. As always, performance, innovative design, ergonomics, special alloys for

critical parts, hand assembly, meticulous quality control – continues to contribute to the Master Power reputation for superbly crafted, durable air tools. A real value leader.

### ***Customer Service – The Real Value***

With products of such superior quality, it's no great challenge to make a sale. The real challenge is providing the courteous treatment, prompt delivery and a full inventory of parts that customers expect. This task is accomplished at Master Power by one of the largest service networks in



the industry where "service after the sale" is not just an afterthought.

***More than just fast local delivery!***



- Your Master Power Distributor maintains a constantly replenished warehouse...a single, convenient source of supply that acts as your tool storehouse.
- Your shipping costs are lower because the shipping point is nearby.
- You deal with people who know your industry as well as their own.

■ Distributor salesmen are trained in the proper use and application of power tools. They are qualified to help you select the right tool for the job.



- You get quick service, catalog and price information, tools and parts, warranty administration, technical help and so much more.
- You get a lot more than just quality power tools when you buy from your Master Power distributor.

**MP Master Power**  
 ® *Value. Performance. Delivery.*





## Warranty

Cooper warrants products and parts sold by it, insofar as they are of its own manufacture, against defects of material and workmanship, under normal use and service in accordance with its written instructions, recommendations, and ratings for installation, operation, maintenance, and service of products, for a period of **ONE YEAR FROM THE DATE OF INITIAL USE, BUT IN NO EVENT SHALL THE WARRANTY EXCEED 24 MONTHS FROM DATE OF DELIVERY TO DISTRIBUTOR.** Proof of Purchase with shipment date must be furnished by the user to validate the warranty. This warranty applies only to products manufactured by Cooper and specifically excludes products manufactured by others. Products not manufactured by Cooper are warranted only to the extent and in the manner warranted to Cooper by the

manufacturer and then only to the extent Cooper is able to enforce such warranty. Cooper's warranty with respect to products manufactured by it is limited to the repair or replacement, as Cooper may elect, of any defective part regarding which the Distributor has given 5 days written notice from the discovery of such defect. Installation and transportation costs are not included. Cooper shall have the option of requiring the return to it of the defective material, transportation prepaid, for inspection. No allowance will be made for repairs without Cooper's approval. **COOPER MAKES NO OTHER WARRANTY OF ANY KIND WHATSOEVER, EXPRESSED OR IMPLIED, AND HEREBY DISCLAIMS ALL WARRANTIES OF MERCHANTABILITY AND FITNESS FOR A PARTICULAR PURPOSE.**

## Lubrication Products

Cooper Power Tools' products are classified as non-hazardous manufactured items, defined in the OSHA 1910.1200 Hazard Communication Standard as "Articles". These products, under conditions of normal use, do not release or cause exposure to a hazardous chemical.

Under normal conditions of use, lubrication products sold separately for or used within these tools should not cause an exposure hazard. Refer to the Material Safety Data Sheet (M.S.D.S.) for Safety and Disposal Information. M.S.D.S. sheets are available upon request from Cooper Power Tools or on our website at [www.cooperpowertools.com](http://www.cooperpowertools.com).

Cooper is also aware of, and complies with, the provisions of section 611 amendments to the Clean Air Act of 1990. No

ozone depleting chemicals have been used in the manufacture of our products.

If you resell or distribute these products, you have the responsibility for ensuring that the Material Safety Data Sheets are provided to the purchaser.

Proper lubrication is essential to the economical operation of pneumatic and electric tools. Cooper Power Tools products perform better and their life is extended by using the recommended lubricants. All lubricants that are listed in the accessory section of this catalog have undergone extensive testing and are recommended for use with Cooper Power Tools products.

## Fastener Selection

The suggested fasteners listed in this catalog are determined by matching a tool's maximum rated load to Society of Automotive Engineers (SAE) Grade 5 and International Organization of Standardization (ISO) Grade 9.8 fasteners. The torque capabilities for SAE Grade 5 fasteners are from SAE Manual, SAE J429 (Mechanical and Material Requirement for Externally Threaded Fasteners). The torque capabilities for ISO Grade 9.8 fasteners are from ISO 898-1 (Mechanical Properties of Fasteners). All values selected are based on lubricated fasteners.

The suggested fasteners listed in this catalog are advisory only, and Cooper Power Tools recommends that you further consult other technical references before final tool selection. Reliance on the accuracy of this catalog data for any purpose by anyone is at the sole risk of that person. Cooper Power Tools is not responsible for any loss, claim, or damage arising from improper tool selection.

The torque values listed under the headings "TORQUE" are tested on an ISO 5393 soft joint rate test fixture unless otherwise stated by a special note.



### WARNING

The signal word "WARNING" indicates a potentially hazardous situation which, if not avoided, may result in minor or moderate injury; and, identifies safe work practices in this operating instruction. Observe these notes and proceed with special care in these cases. Pass all safety instructions on to other users. In addition to these instructions, the general local safety and accident prevention rules must be observed.



### CAUTION

The signal word "CAUTION" identifies all situations meriting special attention to ensure that guidelines, rules, hints and the correct work procedures are observed; and, to prevent damage to and destruction of the machine and/or parts.

## Operational Instructions

- These Cooper Power Tools portable and mountable tools are air powered. **ALWAYS USE CAUTION WHEN USING POWER TOOLS FOR PERSONAL SAFETY.**
- **General Industry Safety & Health Regulations, part 1910, OSHA 2206, available from Superintendent of Documents; Government Printing Office; Washington, DC 20402**

- **Safety Code for Portable Air Tools – ANSI B1861 available from American National Standards Institute, Inc.; 1430 Broadway; New York, NY 10018**
- **State and local regulations.**
- **Use only genuine Cooper Power Tools replacements parts.**





## WARNING

Before mounting any abrasive wheel, buffing wheel, wire brush, saw blade, flap wheel or other product, after all tool repairs and whenever a tool is issued for use, the RPM shall be checked with a tachometer to insure that its actual speed does not exceed rated speed. **GOVERNED TOOLS IN USE ON THE JOB SHALL BE CHECKED AT LEAST ONCE EVERY TWENTY HOURS OF USE, OR ONCE WEEKLY, WHICHEVER IS MORE FREQUENT.** Tachometers must be checked and calibrated on a regular basis according to the manufacturer's recommendations.

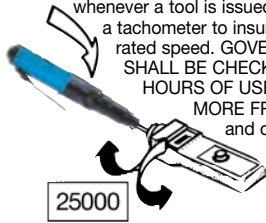

25000



## WARNING

Tools shall be used for purposes intended in their design. Refer to product catalog.



Modification of the tool, or use of non specified accessories, may result in serious injury.



## WARNING



Test and operate tools at 90 PSIG (620 kPa/6.2 bar) maximum pressure (measured at the tool while the tool is running) unless tool is marked otherwise. Use recommended air line filters – regulators – lubricators.

Always remove the air supply hose before working on the tool or changing accessories



## WARNING



Immediately shut off the tool if unusual sound or vibration is detected. Remove and inspect the wheel and check the tool speed (RPM).

Use of over-speeding grinder or unbalanced wheels may result in serious injury.



## WARNING

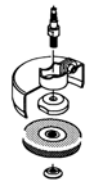

Each type of wheel, wire brush, saw blade, flap wheel and other product, has specific mounting procedures and regulations concerning spindles, flanges, blotters, collets, etc., which shall be used. Wheels must mount on tool's spindle freely but not loosely. Spindle nuts must be tightened so as not to crack the wheel with too much force. Nuts must have all thread engagement.



## WARNING



Regularly inspect all wheels, etc., and discard cracked, chipped or otherwise damaged units. Redress out-of-balance wheels. SEE REGULATIONS.



## WARNING

Select proper guards for the application and mount securely and properly. Always mount guards so that abrasive debris, sparks, etc., are deflected away from the operator. Safety guards shall be in good condition. Any guard which has been subjected to a wheel failure shall be discarded and replaced.



## WARNING

12,000 RPM

Speed rating of abrasive wheel, buffing wheel, wire brush, saw blade, flap wheel, or other products used, must equal or exceed speed rating of tool.

Exceeding the speed of accessories may cause failure of these products and serious operator injury.

Wheels must clearly show the rated speed for its use, or must be discarded and not used.

12,000 RPM MAX



## WARNING

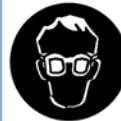

Wear impact resistant goggles or face shield at all times the tool is in operation. Other protective clothing shall be worn, if necessary, for spark protection deflection. SEE REGULATIONS.



## WARNING



High sound levels can cause permanent hearing loss. use hearing protection as recommended by your employer or OSHA. See 29CFR Part 1910.



## WARNING



Employ a safety program to provide inspection and maintenance of all phases of tool operation and air supply equipment in accordance with "Safety Code for Portable Air Tools," ANSI B186.1.

Make sure that all repairs are by trained personnel only and that these safety instructions are understood by the user.



## WARNING



When mounting any grinding wheel, the tool shall be run at operating speed with the safety guard in place, in a protected area such as under a work bench, for at least one minute. A damaged wheel should fail within that time.

Any suspect wheel of unknown origin shall not be used and must be properly disposed.







## The solution for finishing it right.

Master Power offers one of the most complete range of pneumatic equipment for rubbing, sanding and polishing in the world today. Master Power products are in demand by craftsmen and professionals in a wide variety of industries throughout the world. If you are working with wood, composites, solid surface, metal or stone, Master Power has a product that will provide a cost effective finish to your exacting standards.

### Major Product Improvements

Significant improvements have been made across the complete range of Master Power products to assure you, our customer, of our continued commitment to enhance your productivity. Just a few of the improvements that will benefit you and make your work more pleasurable: Less Vibration . . . Quieter Running . . . More Power . . . Ease of Repair . . . Reduction in Parts Inventory.

When you want the best, ask for Master Power! Available from your Industrial Distributor.

**MP4403-05**  
(with 3/32" chrome lever)



**MP4470-09**





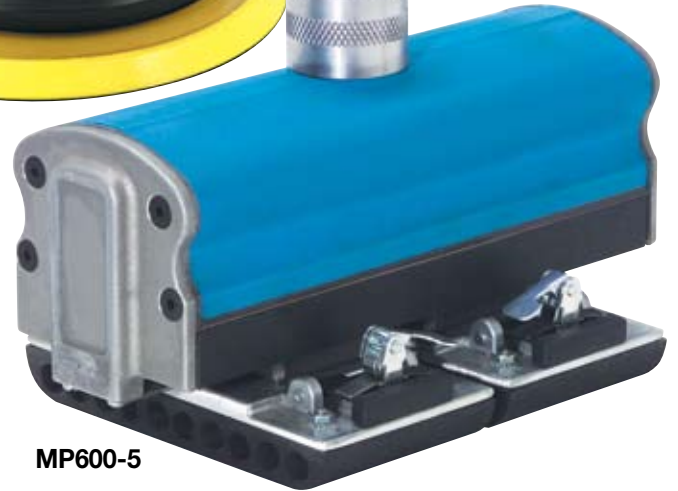
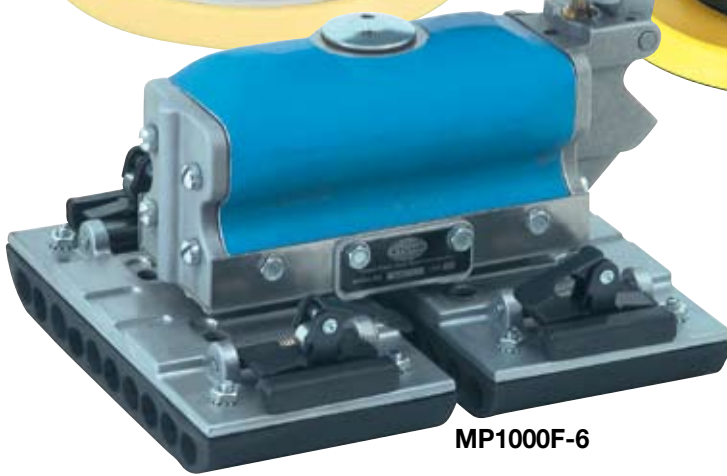



## MP4400 Series Random Orbital Sanders

- New improved air shield shaft balancer for longer bearing life.
- The low profile gives the operator more sanding control and greater comfort.
- Consumes less air than comparable tools— ideal for small shops with smaller compressors, yet can run economically in large industrial plants.
- Light weight & low vibration are benefits attributed to the use of high-strength polymer materials. All the qualities of metal without the weight!
- 3/16" orbit pattern for fine finishing or 3/32" orbit pattern for superb finishing.
- Levers allow users to visually see difference between 3/16" & 3/32" tools.

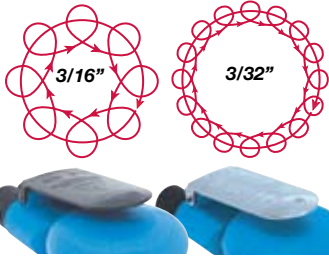

*Durable high carbon steel lever won't break off*

*Sintered bronze one piece muffler does an excellent job of muffling noise and does not clog as easily as competitive models. When needed, makes servicing tool easy.*

*3 interchangeable grips to reduce fatigue and increase user comfort shipped standard with every sander*



*Hardened alloy steel cylinder for power, speed and longer cylinder life*

*Floating rotor design reduces internal friction for a higher power transfer, simplified maintenance and longer tool life*

*Hardened alloy steel shaft balancer for durability and long wear*

*Underside variable speed control allows user to easily adjust speed for different applications*

*A wide range of industrial-quality PSA and hook and loop pads available in 3", 5" and 6" sizes*

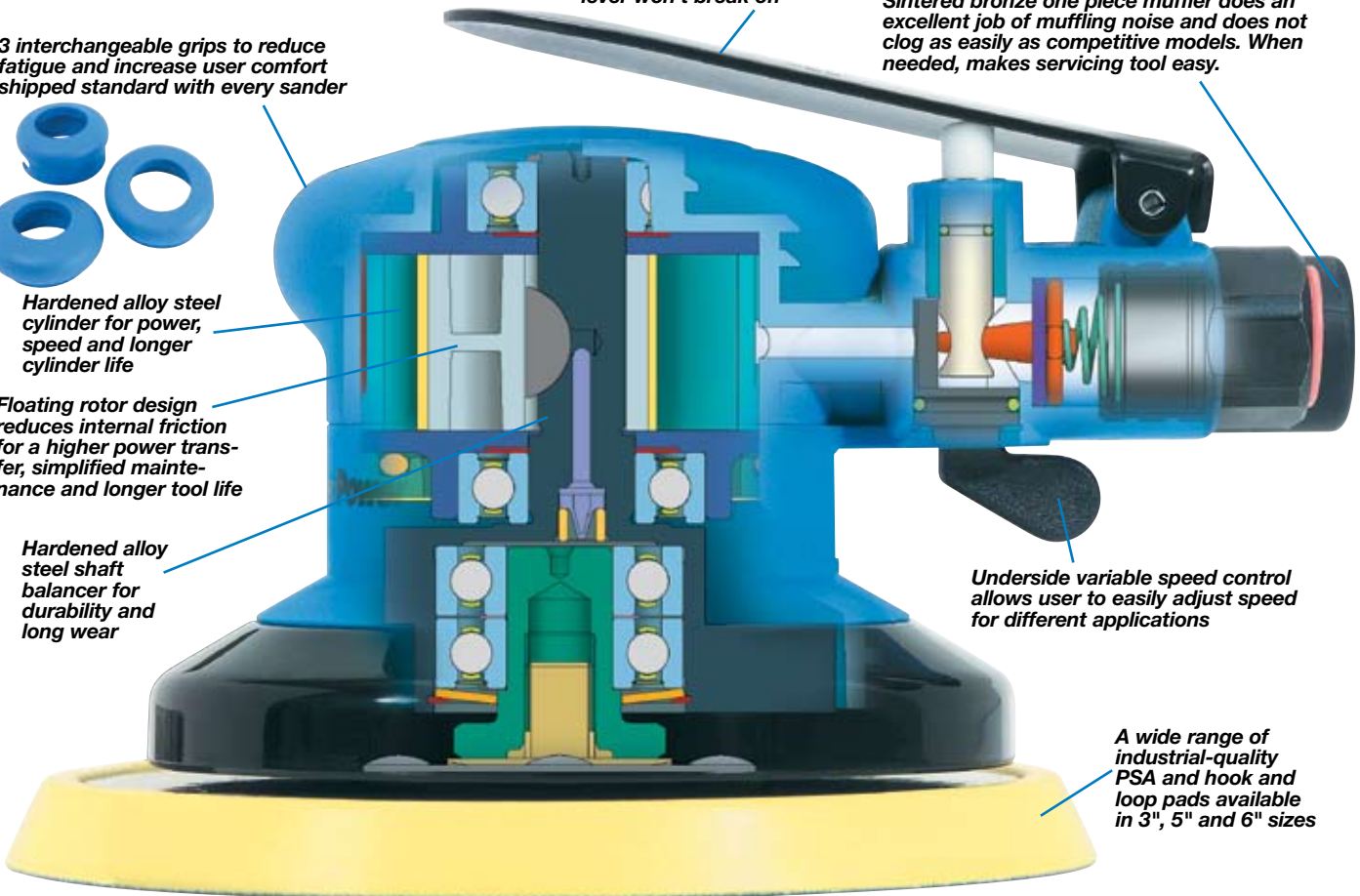



**MP4400 & MP4403 Series Random Orbital Sanders**

Model Number		Backup/Sanding Pad Size	Free Speed RPM	Weight		Height		Length	
3/16"	3/32"			lbs.	kg	in.	mm	in.	mm
<b>12,000 RPM – Non Vacuum</b>									
MP4400-03		3.5	12,000	1.56	0.71	3.33	84.58	5.11	129.79
MP4400-05†	MP4403-05†	5.0	12,000	1.62	0.73	3.33	84.58	5.48	139.19
MP4400-06†	MP4403-06	6.0	12,000	1.68	0.76	3.33	84.58	5.48	139.19
<b>12,000 RPM – Central Vacuum with Shroud</b>									
MP4400-35	MP4403-35HL	5.0	12,000	1.66	0.75	3.33	84.58	7.06	179.32
<b>12,000 RPM – Central Vacuum with Skirt</b>									
MP4400-15	MP4403-15	5.0	12,000	1.73	0.78	3.33	84.58	7.75	196.75
<b>12,000 RPM – Self Generated Vacuum, Floor Bag, Hose &amp; Skirt</b>									
MP4400-23		3.5	12,000	1.60	0.73	3.33	84.58	7.99	202.95
MP4400-25		5.0	12,000	1.73	0.78	3.33	84.58	8.33	211.58

**General**

Air Inlet 1/4" NPT  
 Min. Hose Size: 3/8"  
 Tool performance rated at 90 psi (620 kPa) air pressure.  
 All threads are 5/16"-24  
 Maximum SCFM: 17

**Standard Equipment:**

Operating instructions & parts manual  
 3/8" low profile, medium density premium urethane back-up pad  
 Interchangeable grips (3): 70421900 – 2 1/2"  
 70422000 – 2 3/4"  
 70422100 – 3"

**Optional Equipment:**

Vac Hose 100704300  
 Spare Parts Kit 88004400  
 Rotor & Vane Kit 70444800  
 † Hook and Loop model available

**MP4400-03**



**MP4400-05**



**MP4403-05 (with 3/32" chrome lever)**



**MP4400-06**



**MP4400-35**





## MP4470 Series Orbital Sanders

- Lightest weight full size orbital sander in the world.
- Consumes less air than comparable tools—ideal for small shops with smaller compressors, yet can run economically in large industrial plants.
- Light weight & low vibration are benefits attributed to the use of high-strength polymer materials. All the qualities of metal without the weight.
- Patent pending pad suspension system that produces unmatched performance.
- 3/16" orbit pattern for fine finishing.
- 3 interchangeable grips (shipped standard with each tool) means less fatigue and greater user comfort no matter what the hand size.

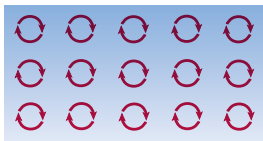

MP4470-09

### MP4470 Series 3/16" Orbital Sanders

Model Number - 3/16" Clip	Abrasive Size	Free Speed	Weight		Height		Length		Width	
		OPM	lbs.	kg	in.	mm	in.	mm	in.	mm
10,000 OPM - .24 hp (179 W) – Non Vacuum										
MP4470-09	3 2/3" x 9"	10,000	2.28	1.03	3.94	100.01	6.88	174.63	3.53	89.69

**General:**  
 Air Inlet 1/4" NPT  
 Min. Hose Size: 3/8"  
 Tool performance rated at 90 psi (620 kPa) air pressure.  
 Maximum SCFM: 16.3

**Standard Equipment:**  
 Operating instructions & parts manual  
 3/8" low profile, medium density premium urethane back-up pad  
 Interchangeable grips (3): 70421900 – 2 1/2"  
 70422000 – 2 3/4"  
 70422100 – 3"

**Optional Equipment:**  
 Vac Hose 100704300  
 Spare Parts Kit 70494300  
 Rotor & Vane Kit 70493600

### Service Repair Tools

Not supplied with tool.



**Lock Ring and Spindle Puller**  
 MP4400 & MP4403 Series 70420000  
 MP4470 Series 70505200



70420100  
Service Clamp

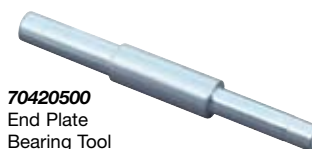

70420500  
End Plate  
Bearing Tool



70505200†  
Sander Motor Removal

† Quotation required.



## Backup Pads For Random Orbital Sanders

### Low Profile Backup Pads for Random Orbital Sanders

A thinner, harder pad generally recommended for aggressive sanding and leveling of flat surfaces.

Diameter	Thickness	PSA Pads		Hook & Loop Pads	
		Non-Vacuum	Vacuum	Non-Vacuum	Vacuum
3-1/2"	3/8"	543025	543025	543026	543026
5"	3/8"	543017	543018	543019	543020
6"	3/8"	543021	543022	543023	543024



### Tapered Edge Backup Pads for Random Orbital Sanders

A thicker, softer pad generally recommended for contour sanding and feather edging.

Diameter	Thickness	PSA Pads
		Non-Vacuum
5"	3/4"	543041
6"	3/4"	543042



### Backup Pads for Orbital Sanders

PSA adhesion to tool eliminates the need for any tools when changing pads. Pad remains flat throughout full orbit at any speed.

Diameter	Thickness	PSA Pads		Hook & Loop Pads	
		Non-Vacuum	Vacuum	Non-Vacuum	Vacuum
3-2/3"x7"	3/8"	543011	543013	543012	543014†

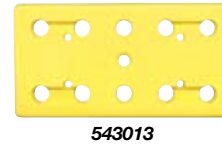

† Quotation required.

## All Pads Are Not Created Equal

The backing pad is a very important interface between the tool and your work. A quality pad performs three main functions. First, it provides a flexible, yet flat surface to mount the abrasive to the tool. Second, a quality pad has a controlled weight and mass that balances with your tool and allows the tool to operate with minimum vibration. Third, a quality pad will be long lasting. The difference between quality pads and other pads can be seen in their components and construction.

### Our quality pads have:

**1 A specially designed, environmentally friendly, molded polyurethane foam**, that dampens vibration to prevent your tool from bouncing, yet is flexible and tough enough to withstand the rigorous operation of dual-action random orbit sanders. A permanent bond between the polyurethane and other components of the pad eliminates separation problems.

**2 A rugged thermoset fiberglass epoxy backing**, that withstands the abuse of heat, flexing and impact, to keep the pad running flat and true for a long time. Aluminum backings bend from impact and lose their flatness, while heat and flexing cause molded plastic backings to warp, distorting the face of the pad. A pad that is not flat causes vibration which fatigues the user and prevents creating a professional finish.

**3 Full 1/2" diameter vacuum holes** that match standard paper and allow maximum performance of your tools' vacuum system.

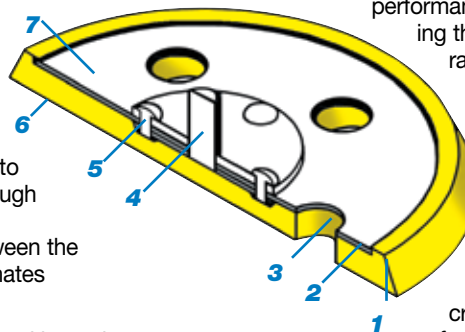

**4 A durable welded and plated stud assembly on random orbital pads.** Welding assures a permanent alignment between the pad and the tool. Plating assures easy pad removal by preventing corrosion.

**5 A stud assembly that is rigidly attached to the backing with four rivets on random orbital pads.** Stud assemblies that are molded in place can loosen and strip, causing poor performance and difficulties when removing the pad from the tool. A large, flat, raised steel washer with a four rivet attachment forms an ideal distributor of stress. This assures perfect alignment with all tools, and allows the pad to remain in service for a long time.

**6 An embossed vinyl facing or hook facing** that is intimately molded with the polyurethane to create a permanent durable and flat surface. Embossed vinyl facings offer maximum adhesion with PSA style paper while operating the tool, yet allow quick and easy replacement. Quality hook facings also offer secure adhesion yet quick and easy removal.

**7 Strict tolerance on weight, balance, roundness, and flatness.** A pad that is not the correct weight, out of round, out of balance, or uneven causes vibrations which fatigue the user and prevents creating a professional finish. Strict tolerances assure you that each pad performs consistently for a long time.





## MP600 Series Sanders/Polishers

- 1200 SPM
- Rugged, powerful machine for rubbing, sanding and polishing large flat surfaces
- Pads driven by horizontally opposed pistons: Minimized operator fatigue
- More power: To handle all top coat rubbing, finishing operations faster and easier
- Precision machined slide assembly: Smoother more consistent finish
- Opposed straight line
- Wet or dry applications



## MP1000 & MP4000 Series Sanders/Polishers

- Opposed straight line
- Wet or dry rubbing, sanding or polishing
- Double padding provides fast, superb finishes
- Pads powered by horizontally opposed inline pistons
- Large abrasive area: 70 square inches
- Compact and smooth running
- Beautifully finished with precision machined slide assembly

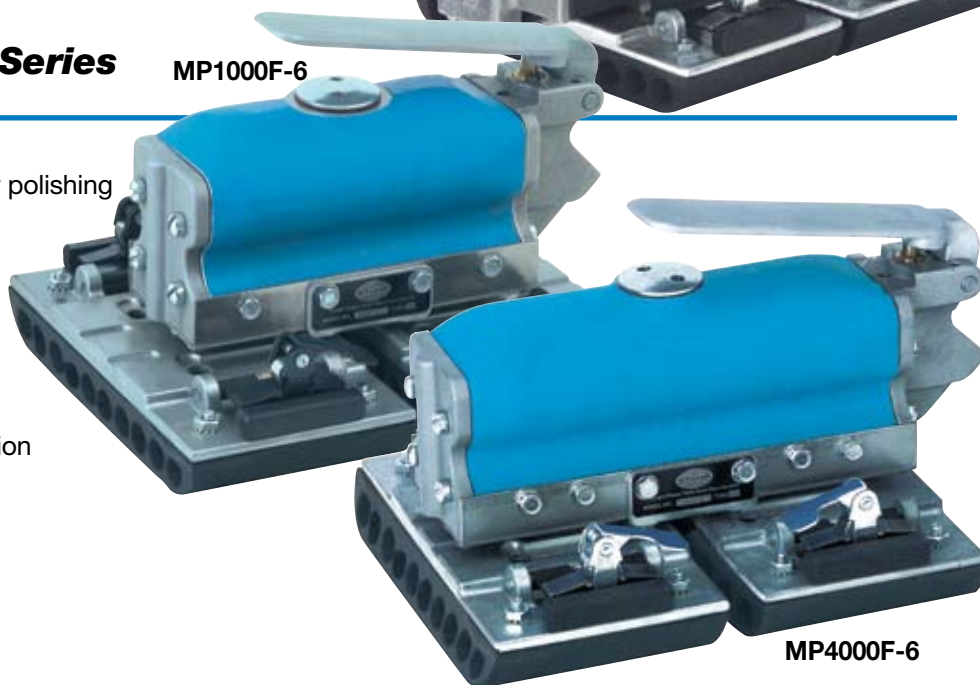

Model Number	Pad Type	Stroke (ins.)	Speed	Paper Capacity	Weight	
			SPM	Sheets	lbs.	kg

### MP600 Series:

#### 1/3 Sheet Capacity

MP600-5	Soft Tubular Rubber	1-1/2"	1200	4-8	30	13.61
---------	---------------------	--------	------	-----	----	-------

### MP1000 & MP 4000 Series:

#### Tool without Shoes

MP1000F-1	None	7/16"	3700	4-8	7.5	3.40
-----------	------	-------	------	-----	-----	------

#### 1/4 Sheet Capacity

MP1000F-7	Soft Mattress	7/16"	3700	4-8	7.5	3.40
-----------	---------------	-------	------	-----	-----	------

#### 1/3 Sheet Capacity

MP1000F-6	Soft Tubular Rubber	7/16"	3700	4-8	7.5	3.40
MP4000F-6	Soft Tubular Rubber	3/4"	3100	4-8	9.0	4.08

#### General:

Air Inlet 1/8" NPT  
Use 1/4" (6.4 mm) I.D. hose.  
All tools performance rated @ 75psi (517 kPa) air pressure.

#### Equipment: Shoes & Pads

**1/4 Sheet**  
Shoe Assembly: URM1041 (complete with sandpaper clamps)  
Pad Assembly: URM1053 1/2" Felt  
Pad Assembly: URM1108 3/4" Felt  
Pad Assembly: URM1049-B Soft Mattress  
Pad Assembly: URM1050-3 Soft Tubular Rubber

#### 1/3 Sheet

Shoe Assembly: URM700 (complete with sandpaper clamps)  
Pad Assembly: URM2119 3/8" Felt 3-2/3"x9"  
Pad Assembly: URM2131 1/2" Felt 3-2/3"x9-3/4"  
Pad Assembly: URM2166-2 Soft Tubular Rubber 3-2/3"x9"





### Random Orbital Sander

- 9,500 OPM
- Precise feathering throttle produces a better finish
- Built in air regulator for maximum operator control
- Lightweight yet durable composite handle
- Removable handle for right or left hand operation



MP4425



### Heavy Duty High Speed Disc Sander

- Ideal for feather edging, light sanding and rust removal
- Designed to sand contours and hard to reach areas
- Variable speed regulator for on-the-job adjustment
- Ergonomic grip for operator comfort
- Lower dBA and lighter than competitive models



MP6151

Model Number	Free Speed OPM	Disc Capacity	Length		Weight		Hose Size		Air Consumption CFM	Air Inlet NPT
			in.	mm	lbs.	kg	in.	mm		
<b>Orbital/Random Orbital</b>										
MP4425	9,500	6"	8	203	2.9	1.3	1/4	6.4	20	1/4"
<b>Disk</b>										
MP6151	14,000	5"	6 5/16	160	2.1	.95	3/8	10	22	1/4"

**General:**  
 Air Inlet 1/4" NPT  
 Use 3/8" (9.52 mm) I.D. hose MP4425  
 Use 1/4" (6.4 mm) I.D. hose MP6151  
 All tools performance rated @ 90psi (620 kPa) air pressure.

**Standard Equipment:**  
 Owners Manual  
 Parts Sheet  
 MP4425: 543021 6" PSA pad

**Optional Accessories:**  
 6" H&L pad for model MP4425 - No. 543023  
 60538 Master Guard oil (4 oz.)  
 60539 Master Guard oil (1 qt.)  
 63593 8' Hose whip  
 22034 Hose line oiler





## MP8000, MP8001 & MP8002 Series Air Vacuums

- Moves water fast. Powerful motor delivers 116" water lift, 110 SCFM flow, and 60 gpm water pick-up capacity
- Low noise
- Lasts longer with little maintenance. No moving parts

- Increased power and efficiency from venturi system
- Overflow valve standard with all units
- Fine material filtering, down to 5 micron.
- Safe because it uses no electricity. Pick-up wet or dry and in other hazardous conditions\*
- Cast aluminum epoxy coated heads for maximum corrosion resistance
- Recommended air supply hose size 1/2" I.D.



**\*CAUTION:** VACUUM MUST BE GROUNDED AND CONDUCTIVE HOSE USED TO CONTROL STATIC ELECTRICITY.

Model Number	Description	Pick-up Hose	Water Lift	Flow SCFM	Weight lbs.	C.F.M @ 90 PSIG	Air Inlet	Standard Equipment
MP8000	6 Gallon Wet/Dry Air Vac	1 1/2"	116"	110	19.3	5.5	3/8"	10' x 1 1/2" Vinyl hose #710040 Two Stage filter cartridge #718460
MP8001	20 Gallon Wet/Dry Air Vac	1 1/2"	116"	110	39.5	5.5	3/8"	10' x 1 1/2" vinyl hose #710040 Two Stage filter cartridge #718461 Extra Heavy Duty 3 Wheel Dolly
MP8002	55 Gallon Wet/Dry Air Vac (Tank not included)	1 1/2"	116"	110	18.5	5.5	3/8"	10' x 1 1/2" vinyl hose #710040 Two Stage filter cartridge #718462

**Note:** Foam Muffler 80098300 used on all vacuums to reduce noise.







No. 710006 floor tool with brush, non metallic



No. 710009 floor tool, metal with brush



No. 710011 floor tool, metal



No. 710012 squeegee tool, plastic



No. 710013 12" floor tool



No. 710014 11" crevice, plastic



No. 710015 18" bulk pickup nozzle, aluminum



No. 710016 6" Nozzle



No. 710017 overhead pipe cleaning tool (for pipes over 6" dia.)



No. 710018 overhead pipe cleaning tool (for pipes 4-6" dia.)



No. 710025 non metallic bulk pickup nozzle



No. 710026 aluminum dust brush



No. 710027 aluminum crevice tool



No. 710028 dust brush, plastic



No. 710030 single bend aluminum extension



No. 710031 one piece wand, double bend



No. 710032 aluminum extension, 54"



No. 710033 one piece double bend aluminum extension



No. 710034 Floor wand 2 piece 54" metal



No. 710040 10' x 1 1/2" vinyl hose

No. 710041 15' x 1 1/2" vinyl hose

No. 710043 25' x 1 1/2" vinyl hose



No. 710044 conductive static hose with cuff 10' x 1 1/2"

No. 710045 conductive static hose with cuff 20' x 1 1/2"



No. 800992 coupling for 20' conductive hose



No. 710051 crevice tool



## Master Power air drills. Built to perform...designed to last.

DRILLS



### Productivity

**High Power-to-Weight Ratio** – Assures operator comfort in handling Master Power drills.

**Gear Trains** – Master Power gears are carefully engineered and precision cut to transmit power and high speed in a small space.

**All Ball and Roller Bearing Construction** – Precision ball and roller bearings are used at vital wear points for reduced friction, minimized wear, smooth, quiet operation and extended tool life.

**Rugged Construction** –

The science of ergonomics, the interface between man and machine, is employed throughout Master Power designs to achieve maximum control and ease of handling.



MP1463-51

MP1454-38



## Adaptability

**Throttle Options** – Two-stage Unitized Valve Throttle.

This 2-speed throttle allows the operator to locate and start the drill accurately at slow speed and prevent damage to the workpiece. Full speed is achieved with full pressure on the throttle. (Provided on most pistol grip models.)

**Versatility** – Master Power drills are easily converted to direct drive screwdrivers with slip chucks.

## Handleability

**Quiet operating** – Another application of ergonomics to Master Power drills, is design which limits tool noise to within standards.

**Two Exhaust Systems** – Drill motors have either 360° rotatable or rear exhaust. Rear Exhaust models are designed to vent exhaust harmlessly and quietly away from the work area, while 360° rotatable side vented exhaust models allow the operator to deflect the exhaust to the most advantageous direction.



**MP1457-51**

## Serviceability

**Parts Interchangeability**

– Many Master Power tools are constructed of standard unitized parts which allows for greater parts interchangeability and adaptability.





# Pistol Grip Drills

Reversible & Non-Reversible



## MP1454-38

- Nominal Motor Power  
0.3 hp / 0.22 kW
- Ergonomic design with comfort grip
- Small size ideal for tight access areas; handle is almost 90° to the spindle
- Variable speed trigger
- Handle exhaust
- Only 1.5 lbs.



MP1454-38

## MP1457-51

- Nominal Motor Power  
1 hp / 0.745 kW
- Non-Reversible
- Double row ball bearings on output spindle for excellent alignment and true running bits
- Parts interchangeable with Master Power screwdrivers
- Steel front end for industrial applications
- 2 step throttle for easy starts
- Built-in no-clog mufflers for quiet operation
- Hardened and ground precision parts for extended service life



MP1457-51

Model Number	Free Speed	Hp.	Chuck Capacity	Length		Weight		Spindle Offset		Air Consumption	Air Inlet
	RPM			in.	mm	lbs.	kg	in.	mm	CFM	
MP1454-38	3000	.30	1/4"	5.5	139.7	1.5	.68	-	-	12	1/4"
MP1457-51	2800	1.0	3/8"	7.5	191.0	1.9	.85	.84	20.6	25	1/4"

**General:**

Air Inlet: 1/4" NPT – Use 1/4" (6.4 mm) I.D. hose  
All tools performance rated @ 90psi (620 kPa) air pressure

**Standard Equipment:**

Chuck and Key  
Owners Manual  
Parts Sheet



# Pistol Grip Drills

Reversible & Non-Reversible



## MP1463-51

- Nominal Motor Power  
1 hp / 0.745 kW
- Reversible
- Ball bearings on output spindle for excellent alignment and true running bits
- Parts interchangeable with Master Power screwdrivers
- Steel front end for industrial applications
- 2 step throttle for easy starts
- Built-in no-clog mufflers for quiet operation
- Hardened and ground precision parts for extended service life



MP1463-51

## MP1458-55

- Nominal Motor Power  
1.2 hp / 0.894 kW
- Non-reversible
- Ball bearings on output spindle for excellent alignment and true running bits
- Parts interchangeable with Master Power screwdrivers
- Steel front end for industrial applications
- 2 step throttle for easy starts
- Built-in no-clog mufflers for quiet operation
- Hardened and ground precision parts for extended service life



MP1458-55

**DRILLS**

Model Number	Free Speed	Hp.	Chuck Capacity	Length		Weight		Spindle Offset		Air Inlet
	RPM			in.	mm	lbs.	kg	in.	mm	
MP1463-51	1800	1.0	3/8"	6.8	172.7	2.5	1.1	.84	20.6	1/4"
MP1458-55	1400	1.2	1/2"	9.0	228.6	2.1	.95	.84	20.6	1/4"

**General:**

Air Inlet: 1/4" NPT – Use 1/4" (6.4 mm) I.D. hose  
All tools performance rated @ 90psi (620 kPa) air pressure

**Standard Equipment:**

Chuck and Key  
Owners Manual  
Parts Sheet





# Master Power Fastening Tools... A Complete Line To Help Keep Production Schedules Tight.

## Productivity

**Powerful High Torque Output** – Master Power Fastening tools are designed to provide slightly more torque (with throttle wide open) than will be required for the largest fastener on which the tool will be used. Variations of torque can be controlled by the addition of a clutch, use of less air pressure, or using a different RPM tool.

**Integral Quick Change Chuck** – Many Master Power pneumatic screwdrivers are equipped with quick change bit adapters, or 'slip bit adapters', to allow quick change and positive retention of 1/4" hex bits, bit and finder combinations, insert bit holders, socket adapters and many other accessories.

## Reversibility

– Reverse action is standard on all Master Power screwdrivers and nutrunners. The reversibility feature enables the operator to remove rusted, cross-threaded or extra-tight fasteners to make assembly adjustments.

MP2453



## Durability

### Rugged Construction/Ergonomics –

The science of human engineering is integrity in the design of every Master Power Air Tool to provide maximum control and ease of handling for the operator. The weight and shape

of a particular tool are determined by the selection of the proper motor for the tool's duty rating. Many housings are shaped to fit hand contours while providing a lightweight, yet rugged and "functional jacket."

Other tools have rugged, functional handles which make the tools easily maneuverable and allow pressure to be applied in critical operations. Each housing is built to withstand abusive



MP2276







use and provide years of maintenance-free service.

**Heavy-Duty Spiral Bevel Gears** – Used in Master Power angle head tools are made of durable, extra-strong materials to provide smooth, efficient power transmission and long trouble-free service.

**Planetary Gearing**

– To provide maximum service life, Master Power's wide selection of planetary gearing is made from extra strong, specially heat treated materials. Gears are carefully engineered and precision cut to special form. They achieve maximum strength, carry high speed and transmit power in a small space. The entire planetary system is amply supported on precision bearings and can be externally lubricated.

**Handleability**

**Push-To-Start** – A standard with torque control tools and available with most clutch models; a real time and air savings feature.

**Tool speed and torque requirements**

The function of torque in a fastening tool is to provide tension in a bolt or screw . . . proper torque is a means of arriving at desired bolt or screw tension. On fastening tools, torque accuracy can be controlled by the kind of clutch used, or by motor RPM. With Master Power Air Tools, increased torque control can generally be obtained by (in order of increased control): a positive clutch, an adjustable clutch, a torque control clutch, and a precision clutch for the most control. Master Power Screwdrivers and Nutrunners are rated in terms of 'free speed' (the RPM of the drive spindle with no load at recommended air pressure and the throttle wide open). A calibrated torque wrench can be used to check torque on the job. Proper tool speed should be selected so that stall torque is greater than, or at least equal to, the torque required for



**FASTENING**



# Screwdrivers & Nutrunners

## Requirements

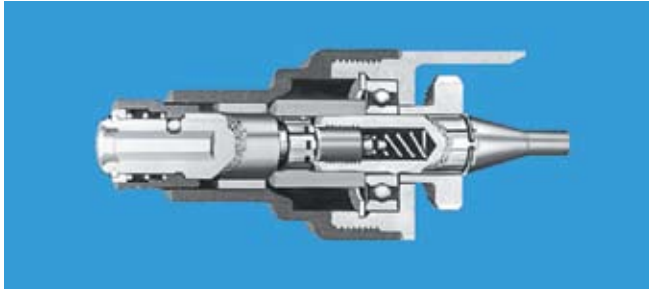

**Direct drive or "Stall Drive"** rotates the fastener until resistance overcomes motor power and motor stalls. Torque is set by adjusting air pressure.

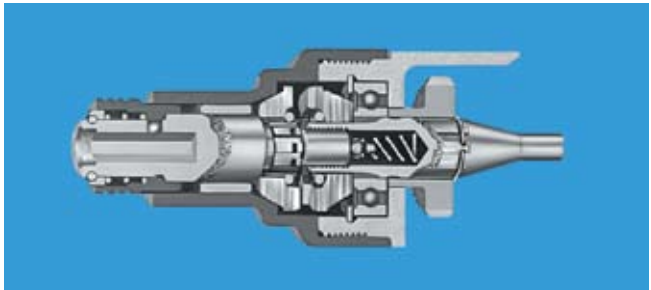

**Positive Clutch** is a good general purpose clutch for soft draw applications in wood and aluminum. Torque output is determined by the force applied by the operator.

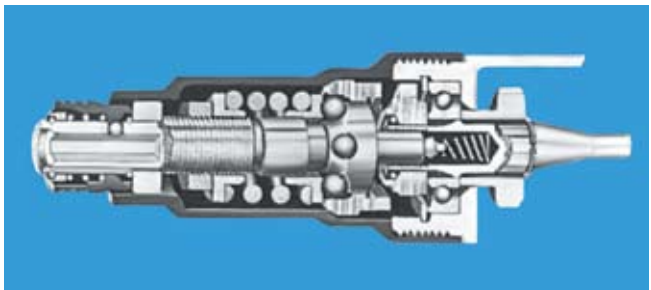

**Adjustable clutch** offers torque range control independent of operator pressure. When pre-set torque is reached, the clutch slips. Torque output is determined by adjusting the spring force.

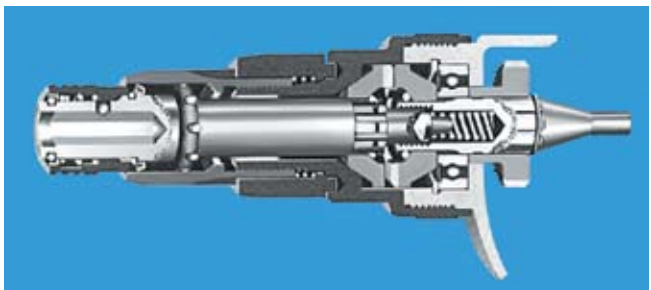

**Versa Clutch** allows the operator to externally adjust the engagement of the clutch plates providing a full range of torque (5-140 In. Lbs. – .56-15.8 Nm) "if ever there was an all-purpose screwdriver for all trades, this is it." When torque is reached, the operator can push and re-engage the clutch jaws to obtain more torque.

## FASTENING

the largest screw or bolt and nut on which the tool will be used. While lower RPM tools provide higher torque, and their torque can be more closely controlled, they increase fastener run-down time. Therefore, if run-down time is an important cost factor, a compromise between accuracy and speed must be reached.

**MP2465**



### Clutch Types

Master Power fastening tools are available with Direct Drive or a choice of clutches: positive, adjustable, or Versa™, or PrecisionMaster™ (see page 35).

With a broad selection of clutches and motors, the Master Power line of tools covers a wide range of torque at several speeds. Coupled with rugged construction and integral drivers, these tools are suitable for an indefinite number of applications.



**Size and Type of Screw, Nut, or Bolt** – When ordering Master Power screwdrivers and nutrunners, you must first know the size and type of fasteners to be used. This determines the proper bit or socket for the job. When ordering a screwdriver, the type of screw head and diameter of the screw should always be specified.

**Kind of Fastening Job** – The kind of clutch best suited to a particular job depends upon the resistance characteristics on the screw or bolt. The six most common types of assembly jobs are described in the table below. The table evaluates the performance of the clutches available for each kind of job.

<b>CLUTCH SELECTION GUIDE</b>					
<b>Typical Screwdriving Jobs</b>		<b>Excellent</b>	<b>Good</b>	<b>Fair</b>	<b>Poor</b>
<p><b>1. FREE RUNNING – SUDDEN STOP</b></p> <p>Turns easily until screw head or nut seats against a solid stop. Resistance builds up rapidly.</p>	Auto Shut Off	Versa Clutch Adjustable	Positive	Direct Drive	
<p><b>2. SOFT PULL-UP</b></p> <p>Turns easily until screw head or nut seats, then resistance builds up gradually through one or more turns as resilient material is compressed.</p>	Adjustable Auto Shut Off	Versa Clutch Positive	Direct Drive		
<p><b>3. SELF TAPPING IN THICK MATERIAL</b></p> <p>Increasingly heavy resistance through entire travel until screw head seats. Then either (A) gradual or (B) sudden final buildup of resistance.</p>	Versa Clutch Positive	Adjustable Direct Drive		Auto Shut Off	
<p><b>4. SHEET METAL SCREWS</b></p> <p>Resistance increases rapidly, eases slightly, then builds rapidly when screw head seats.</p>	Versa Clutch	Adjustable	Positive Auto Shut Off	Direct Drive	
<p><b>5. LOCKNUTS</b></p> <p>Starts with heavy resistance that lasts through entire travel until screw or nut seats. Then either (A) gradual or (B) sudden further buildup of resistance.</p>	Versa Clutch	Adjustable Direct Drive	Positive	Auto Shut Off	
<p><b>6. WOOD SCREWS</b></p> <p>Starts with small resistance that steadily increases through entire travel with additional resistance as screw head seats.</p>	Positive Versa Clutch Direct Drive			Adjustable Auto Shut Off	

**FASTENING**



# Screwdrivers

Direct Drive



## Direct Drive Screwdrivers

- Torque Range  
Up to 120 In. Lbs  
Up to 13 Nm
- Reversible
- 1/4" Hex Quick Change
- Balanced design offers easy handling and control to reduce operator fatigue
- High parts interchangeability
- Side to center 13/16" (20.64 mm)



MP2453



MP2454

FASTENING

Model Number	Free Speed RPM	Torque Rating				Wood Screws (in oak)	Thread Cutting Screws	Machine Screws	Sheet Metal Screws	Length		Weight		Air Consumption CFM
		Hard Slam		Soft Pull						in.	mm	lbs.	kg	
		In.Lbs.	Nm	In.Lbs.	Nm									
MP2452	2800	65	7.2	30	3.3	#8	#8	#10	#10	6.6	168	2.2	.99	22
MP2453	1800	75	8.3	55	6.1	#12	1/4"	1/4"	1/4"	5.6	168	2.2	.99	22
MP2454	1100	120	13.6	85	9.4	#14	1/4"	5/16"	5/16"	7.5	190	2.6	1.2	22

**General:**  
Air Inlet 1/4" NPT  
Use 1/4" (6.4 mm) I.D. hose  
All tools performance rated @ 90psi (620 kPa) air pressure.

**Standard Equipment:**  
Owners Manual  
Parts Sheet

**Optional Accessories:**  
60538 Master Guard oil (4 oz.)  
60539 Master Guard oil (1 qt.)  
63593 8' Hose Whip 1/4" I.D.  
22034 Hose Line Oil





## Positive Clutch Screwdrivers

- Torque Range  
Up to 140 In. Lbs  
Up to 15 Nm
- Reversible
- 1/4" Hex Quick Change
- Balanced design offers easy handling and control to reduce operator fatigue
- High parts interchangeability
- Side to center 13/16" (20.64 mm)



**FASTENING**

Model Number	Free Speed RPM	Torque Rating				Wood Screws (in oak)	Thread Cutting Screws	Machine Screws	Sheet Metal Screws	Length		Weight		Air Consumption CFM
		Hard Slam		Soft Pull						in.	mm	lbs.	kg	
		In.Lbs.	Nm	In.Lbs.	Nm									
MP2464	2800	75	8.5	30	3.4	#8	—	#10	#10	6.6	168	2.5	1.1	22
MP2465	1800	100	11	45	5.1	#8	1/2"	3/4"	1/4"	6.6	168	2.5	1.1	22
MP2465SR	1800	120	13.6	54	6.1	#14	1/2"	3/4"	1/4"	6.6	168	2.5	1.1	22
MP2466	1100	140	15.9	85	9.6	#14	1/4"	5/16"	5/16"	8.1	205	3.1	1.4	22

**General:**  
Air Inlet 1/4" NPT  
Use 1/4" (6.4 mm) I.D. hose  
All tools performance rated @ 90psi (620 kPa) air pressure.

**Standard Equipment:**  
Owners Manual  
Parts Sheet

**Optional Accessories:**  
60538 Master Guard oil (4 oz.)  
60539 Master Guard oil (1 qt.)  
63593 8' Hose Whip 1/4" I.D.  
22034 Hose Line Oil



# Screwdrivers

Adjustable Clutch



## Adjustable Clutch Screwdrivers

- Torque Range  
12 - 140 In. Lbs  
1.4 - 15 Nm
- Reversible
- 1/4" Hex Quick Change
- Balanced design offers easy handling and control to reduce operator fatigue
- High parts interchangeability
- Side to center 13/16" (20.64 mm)



MP2477



MP2474

FASTENING

Model Number	Free Speed RPM	Torque				Screw Size		Length		Weight		Air Consumption
		Hard Slam		Soft Pull		in.	mm	in.	mm	lbs.	kg	CFM
		In.Lbs.	Nm	In.Lbs.	Nm							
<b>Pistol Grip</b>												
MP2476	2800	20-75	2.3-8.5	12-30	1.4-3.4	#10	5	8.5	216	2.9	1.3	22
MP2477	1800	37-100	4.2-11	30-45	3.4-5.1	#10	6	7.8	197	2.6	1.2	22
MP2478	1100	20-140	2.3-15	17-85	1.9-9.6	1/4"	7	9.1	232	3.4	1.5	22
<b>Inline</b>												
MP2474	1800	37-100	4.2-11	30-45	3.4-5.1	#10	6	10.1	257	2.8	1.3	22

**General:**  
Air Inlet 1/4" NPT  
Use 1/4" (6.4 mm) I.D. hose  
All tools performance rated @ 90psi (620 kPa) air pressure.

**Standard Equipment:**  
Suspension bail (lever style only)  
Clutch adjustment wrenches  
Owners Manual  
Parts Sheet  
Standard Clutch Spring  
9111500 MP2476  
8620800 MP2478, MP2474

**Optional Accessories:**  
60538 Master Guard oil (4 oz.)  
60539 Master Guard oil (1 qt.)  
63593 8' Hose Whip 1/4" I.D.  
22034 Hose Line Oiler







## Versa Clutch™ Screwdrivers

- Torque Range  
5 - 140 In. Lbs  
.6 - 15 Nm
- Reversible
- 1/4" Hex Quick Change
- Balanced design offers easy handling and control to reduce operator fatigue
- High parts interchangeability
- Side to center 13/16" (20.64 mm)



MP2436



MP2433

**FASTENING**

Model Number	Free Speed RPM	Torque				Wood Screws (in oak)	Thread Cutting Screws	Machine Screws	Sheet Metal Screws	Length		Weight		Air Consumption
		Hard Slam In.Lbs.	Nm	Soft Pull In.Lbs.	Nm					in.	mm	lbs.	kg	CFM

**Pistol Grip**

MP2436	1800	17-100	1.9-11	5-45	.6-5.1	#12	1/4"	#10	1/4"	7.6	194	2.6	1.20	22
MP2437	1100	5-140	.6-15	5-85	.6-10	#14	1/4"	1/4"	5/16"	8.4	213	3.0	1.40	22

**Inline**

MP2433	1800	17-100	1.9-11	5-45	.6-5.1	#12	1/4"	#10	1/4"	10.2	257	2.9	1.32	22
--------	------	--------	--------	------	--------	-----	------	-----	------	------	-----	-----	------	----

**General:**

Air Inlet 1/4" NPT  
Use 1/4" (6.4 mm) I.D. hose  
All tools performance rated @ 90psi (620 kPa)  
air pressure.

**Standard Equipment:**

Owners Manual  
Parts Sheet  
Suspension Bail

**Optional Accessories:**

60538 Master Guard oil (4 oz.)  
60539 Master Guard oil (1 qt.)  
63593 8' Hose Whip 1/4" I.D.  
22034 Hose Line Oiler



# Impact Nutrunners

Reversible



## MP2260 Series

- High power to weight ratio
- Speed of a screwdriver, power of an impact
- Ideal for soft joint applications
- 4 built-in speed control regulator positions for varying torque output
- Smooth and efficient impact mechanism creates no torque reaction
- Compact clutch design
- 100% ball bearing design
- Reversible
- Detachable belt clip (MP2264, MP2265)



MP2264



MP2265



MP2266

FASTENING

Model Number	Drive In.	Torque Range		Free Speed RPM	Blows Per Minute	Bolt Capacity		Weight		Air Consumption CFM
		Ft.Lbs.	Nm			in.	mm	lbs.	kg	
<b>Pistol</b>										
MP2264	1/4 QC	10-65	13.5-102	10,000	1700	1/2"	10	2.2	1	20
MP2265	3/8 SQ*	10-55	13.5-75	10,000	1400	1/2"	10	2.2	1	20
<b>Inline</b>										
MP2266	1/4 QC	10-65	14.0-88	9,500	1700	1/2"	10	2.2	1	20

**General:**

Air Inlet 1/4" NPT  
Use 1/4" (6.4 mm) I.D. hose  
All tools performance rated @ 90psi (620 kPa)  
air pressure.  
\*Pin retainer

**Standard Equipment:**

Owners Manual  
Parts Sheet

**Optional Accessories:**

60538 Master Guard oil (4 oz.)  
60539 Master Guard oil (1 qt.)  
22034 Hose Line Oiler  
70497000 Flow Regulator  
88007045 Trigger Assembly Kit, MP2264, MP2265





## MP2271

- Reversible
- Full power forward and reverse
- Unique butterfly throttle
- 4 built-in speed control regulator positions for varying torque output



MP2271



MP2276

## MP2276

- Lightweight yet durable composite housing
- Ergonomic grip for improved operator comfort
- Built-in power regulator with four settings
- Reversible

FASTENING

Model Number	Drive In.	Torque Range		Free Speed RPM	Blows Per Minute	Bolt Capacity		Weight		Air Consumption CFM
		Ft.Lbs.	Nm			in.	mm	lbs.	kg	
<b>Inline</b>										
MP2271	1/4 QC	40-50	54-68	10,500	900	3/8"	9.5	2.2	1.0	22
<b>Pistol</b>										
MP2276	3/8 SQ	70-90	95-122	7,500	1100	1/2"	12	3.1	1.4	35

**General:**

Air Inlet 1/4" NPT  
 Use 1/4" (6.4 mm) I.D. hose  
 All tools performance rated @ 90psi (620 kPa)  
 air pressure.  
 \*Pin retainer

**Standard Equipment:**

Owners Manual  
 Parts Sheet

**Optional Accessories:**

60538 Master Guard oil (4 oz.)  
 60539 Master Guard oil (1 qt.)  
 22034 Hose Line Oiler  
 70497000 Flow Regulator  
 88007045 Trigger Assembly Kit, MP2264, MP2265

WARNING: Face & eye protection must be worn while operating power tools, per ANSI B186.1. Cutting tool maximum speed rating must be equal or exceed speed of air tool @ 90 psi (620 kPa). Follow cutting tool manufacturer's mounting & operating instructions.



It is the user's responsibility to refer and comply with ANSI B7.1



# Impact Wrenches

Reversible



## MP2290 Series

- Twin hammer anvil for reduced vibration
- High power to weight ratio
- Built in power regulator with four settings
- 100% ball bearing motor design
- Full power forward and reverse
- Smooth and efficient impact mechanism
- Compact clutch design
- Reversible



FASTENING



Model Number	Drive	Torque Range		Free Speed	Blows Per Minute	Bolt Capacity		Weight		Air Consumption
	In.	Ft.Lbs.	Nm	RPM		in.	mm	lbs.	kg	CFM
MP2294	1/2 (ring ret.)	37-370	50-502	6,500	1400	3/4"	20	5.3	2.4	40
MP2295	1/2 (pin ret.)	37-370	50-502	6,500	1400	3/4"	20	5.3	2.4	40

**General:**

Air Inlet 1/4" NPT  
 Use 1/4" (6.4 mm) I.D. hose  
 All tools performance rated @ 90psi (620 kPa) air pressure.

**Standard Equipment:**

Owners Manual  
 Parts Sheet

**Optional Accessories:**

60538 Master Guard oil (4 oz.)  
 60539 Master Guard oil (1 qt.)  
 63593 8' Hose whip  
 22034 Hose line oiler







## Master Power grinding tools... Efficiency plus durability for every finishing job.

### Handleability

**Lock-Off Lever Throttle** – a feature designed for operator comfort and protection which requires the operator to make two deliberate movements before operating the tool.  
**Quiet Operation** – designed to limit tool noise within acceptable industry standards.

### Durability

**All Ball and Roller Bearing Construction** – Precision ball and roller bearings, used at vital wear points provide reduced friction, smooth, quiet operation, and extended tool life.  
**Rugged Construction** – each tool housing is built to withstand abusive use and provide years of maintenance-free service.

### Adaptability

**Versatility** – Master Power Air Abrasive Tools are available in a variety of styles, designs and configurations wide enough to handle virtually any application . . . from die grinders to right angle sanders to vertical grinders to belt sanders to buffers. Many of these tools can be converted from one use to another . . . from grinder to sander, etc. . . . with available accessories.

MP4200



MP4201



MP4424

MP4458



MP4542







## MP4200 & MP4201

- Ideal for precision deburring, blending and smoothing applications
- Lightweight, ergonomically designed and vibration free
- Rear exhaust directs air away from work
- Standard with 5' air hose and 1' overhose
- Ideal for tight spots
- Slim comfortable design with ergonomic grip for operator comfort
- Double bearings for increased durability on MP4200 inline



**GRINDERS**

Model Number	Hp	Free Speed RPM	Abrasive Capacity		Length		Weight		Hose (I.D.)		CFM	Inlet (NPT)	Collet Size
			Carbide Bur	Diamond Pin	in.	mm	lbs.	kg	in.	mm			
<b>Inline</b>													
MP4200	0.1	70,000	1/4"	1/4"	5.35	136	0.43	0.2	3/16	4.76	8	1/8"	1/8"
<b>Angle</b>													
MP4201	0.1	70,000	1/4"	1/4"	5.9	150	0.43	0.2	3/16	4.76	8	1/8"	1/8"

**General:** Air Inlet 1/4" NPT. Use 1/4" (6.4 mm) I.D. hose.  
All tools performance rated @ 90psi (620 kPa) air pressure.

**Optional:**  
MP4200 - 70617600 collet kit (5 pcs.)  
MP4201 - 70618800 collet kit (5 pcs.)

WARNING: Face & eye protection must be worn while operating power tools, per ANSI B186.1. Cutting tool maximum speed rating must be equal or exceed speed of air tool @ 90 psi (620 kPa). Follow cutting tool manufacturer's mounting & operating instructions.



It is the user's responsibility to refer and comply with ANSI B7.1

# Die Grinders

20,000 to 25,000 RPM



## MP4424 & MP4430 Die Grinders

- Ideal for general purpose applications such as porting, light weld grinding, polishing, and breaking up sharp edges.
- Ergonomic grip for operator comfort
- Built-in power regulator
- 360° air inlet swivel
- Rear exhaust directs air away from work
- 1/4" capacity collet



GRINDERS

## MP4458

- Rugged all steel housing is ideal for rapid metal removal
- Trim ergonomic design enables excellent control
- Front exhaust
- 1/4" capacity collet – 200 Series



Model Number	Hp	Free Speed RPM	Mounted Wheels	Carbide Bur	Length		Weight		Hose (I.D.)		CFM	Inlet NPT	Collet Size
					in.	mm	lbs.	kg	in.	mm			
MP4424	.3	20,000	1"	1/2"	6 3/8	160	1.25	.55	3/8	10	18	1/4"	1/4"
MP4430	.3	23,000	1"	1/2"	6	153	.875	.41	3/8	10	17	1/4"	1/4"
MP4458	.5	25,000	1 1/2"	1"	6 1/16	154	1.3	.60	3/8	10	23	1/4"	1/4"

**General:** Air Inlet 1/4" NPT. Use 1/4" (6.4 mm) I.D. hose. All tools performance rated @ 90psi (620 kPa) air pressure.

**Optional:** MP4424 & MP4430: 70619500 3/16" collet; 70610500 1/4" collet; 70610600 6 mm collet; MP4424: 543944 – 16oz. angle head grease.



# Die Grinders & Wheel Grinders

13,500 to 22,000 RPM



## MP4452 & MP4472 Die Grinders

- Ideal for jobs requiring fast material removal
- Ergonomic grip for operator comfort
- Built-in power regulator
- Rear exhaust directs air away from work
- Heavy-duty grinders with heavy-duty collets



MP4452



MP4472



MP4542

## MP4450 Series Wheel Grinders

- Nominal Motor Power: .7 Hp / .5 kw
- 13,500 RPM
- Type 1 Cut-off and Type 27 Depressed Center Wheels
- Spiral beveled gears, cut and hardened, delivers maximum power
- Compact all steel housing assures outstanding durability
- Floating, self centering rotor for smooth operation
- Safety lock-off throttle
- Full feathering throttle

GRINDERS

Model Number	Hp	Free Speed RPM	Mounted Wheel	Carbide Bur	Length		Weight		Hose I.D.		CFM	Inlet NPT	Collet Size
					in.	mm	lbs.	kg	in.	mm			

### Die Grinders

MP4452	.5	22,000	1 1/2"	1"	6 3/4	171	1.5	.65	3/8	10	20	1/4"	1/4"
MP4472	.7	21,000	1 1/2"	1"	7	178	1.5	.65	3/8	10	28	1/4"	1/4"

Model Number	Exhaust	Free Speed RPM	Hp	Wheel Capacity	Spindle Length		Head Height		Length		Net Wt. w/Guard		Spindle Thread
					in.	mm	in.	mm	in.	mm	lbs.	kg	

### Type 1 Cut-off Wheel

MP4552	Rear	13,500	.7	4"	.65	17	2.3	58	10.8	274	3.2	1.4	3/8"-24
MP4553	Front	13,500	.7	4"	.65	17	2.3	58	10.8	274	3.2	1.4	3/8"-24

### Type 27 Depressed Center Wheel

MP4542	Rear	13,500	.7	4"	.65	17	2.3	58	10.8	274	3.8	1.7	3/8"-24
--------	------	--------	----	----	-----	----	-----	----	------	-----	-----	-----	---------

#### General:

Air Inlet 1/4" NPT  
Use 1/4" (6.4 mm) I.D. hose  
All tools performance rated @ 90psi (620 kPa) air pressure.

#### Standard Equipment:

Owners Manual  
Parts Sheet  
Wheel Wrench

#### Optional Equipment:

MP4452, MP4472: 70619600 – 3/8" collet assembly (nut, collet, collet body)  
70619700 – 3/8" collet body; 70613100 – 1/4" collet

WARNING: Face & eye protection must be worn while operating power tools, per ANSI B186.1. Cutting tool maximum speed rating must be equal or exceed speed of air tool @ 90 psi (620 kPa). Follow cutting tool manufacturer's mounting & operating instructions.



It is the user's responsibility to refer and comply with ANSI B7.1







## MP5173 & MP5174 Scaling Hammers

- 4600 Blows per minute
- Quick change retainer accepts 1/2" diameter round, notched and flattened chisel shanks
- Critical operating parts, piston and bit retainer are made of long wearing tool steel
- Quick change retainer provides greater versatility: permits 4-way chisel positioning
- Valve housing protected through built-in filtering screen of inlet bushing
- Round retainer nose



## MP5187 Lightweight Needle Scaler

- 4200 Blows per minute
- Compact design for work in close quarters
- Almost half the weight of standard models with similar BPM
- Precision heat treated needles for maximum performance



**CUTTING & PERCUSSION**

Model Number	Throttle Handle	Blows Per Minute	Bore		Stroke		Side to Center		Length		Weight	
			in.	mm	in.	mm	in.	mm	in.	mm	lbs.	kg
<b>Scaling Hammers</b>												
MP5173	Lever	4600	1	25	1.1	29	.78	20	9.4	238	3.7	1.6
MP5174	Push	4600	1	25	1.1	29	.78	20	10.6	270	4.0	1.8
<b>Needle Scaler</b>												
MP5187	Lever	4200	.79	20	.59	15	-	-	8.9	225	2.5	1.1

**General:**  
 Air Inlet 1/4" NPT  
 Use 1/4" (9.6 mm) I.D. hose  
 All tools performance rated @ 90psi (620 kPa) air pressure.

**Standard Equipment:**  
 MP5187: 12 needles, 1/8" (3mm) dia., 5" (125mm) long  
 Owners manual  
 Parts sheet

**Optional Equipment:**  
 MP5187: 8913300: 3mmx7" carbon steel flat tip needles  
 80074300: 3mmx7" chisel tip needles  
 71010300: (12) 3mmX5" with 3mm needle holder  
 Refer to page 42 for information on chisels.

# Scalers

Long Reach & Triple Piston



## MP5195 Long Reach Scaler

MP5195



- 2200 Blows per minute
- For rugged scaling applications
- Long reach scaler design for quick and easy stripping of dirt, grease, paint, glue, resins, floor coverings and tiles
- Full Range of chisel blades

Model Number	Blows per Minute	Piston Diameter		Piston Stroke		Length		Weight	
		in.	mm	in.	mm	in.	mm	lbs.	kg
MP5195	2200	1.1	29	1.5	39	60.0	1524	11.5	5.2

**General:**  
Air Inlet 1/4" NPT for MP5195 Model  
Use 1/4" (9.6 mm) I.D. hose  
All tools performance rated @ 90psi (620 kPa) air pressure.

**Standard Equipment:**  
51741 4" 5/8 hex chisel  
Owners manual  
Parts list

**Optional Accessories:**  
51741 4" chisel, 5/8 hex  
51742 2" chisel, 5/8 hex

51743 8" scraper w/replaceable blade  
51744 12" scraper w/replaceable blade  
51745 2" alum. bronze non-spark pack  
51746 8" replacement blade for 51743 8" scraper  
51747 12" replacement blade for 51744 12" scraper  
51749 4" non-spark chisel

## Accessories

Model Number	Description
<b>MP5173, MP5174</b>	
51710	Needle scaler attachment with 1 set of 19-3 mm round needles
<b>Needle scaler sets for 51710 attachment (above)</b>	
51700	1 set of 19-3 mm round needles
51712	5 sets of 19-3 mm x 7", flat tip needles
51713	5 sets of 19-3 mm x 7", chisel tip needles
51714	5 sets of 19-3 mm x 7 in., pointed tip needles
<b>Non-sparking naval bronze needle scalers for MP5195</b>	
51737	5 sets of 19-3 mm x 7", flat tip
51738	5 sets of 28-3 mm x 7", flat tip

Model Number	Description	Length		Point Size
		in.	mm	
<b>Non-Rotating Scaling Hammer Chisels for Models MP5173 &amp; MP5174, 1/2" diameter shank</b>				
718479	Chisel Blank	7.5	190.5	5/8"
718480	Angle Chisel	7.5	190.5	1 3/8"
718481	Flat Chisel	7.5	190.5	1 3/8"
718482	Flat Chisel	8	203.2	3/4"







## MP5160 Series

- 3,000 - 4,000 blows per minute
- Rated for continuous production use
- Precision feathering throttle for positive bit control
- 360° exhaust deflector. No blow back of chips, air, dust
- Patented interlock quick-change spring holds bits securely, permits easy, quick bit changes
- Replaceable steel nose bushing saves on cost of replacing complete barrel (MP5164 and MP5168)
- Side to center 13/32" (27.8mm)



**CUTTING & PERCUSSION**

Model Number	Blows Per Minute	Bore		Stroke		Length		Weight	
		in.	mm	in.	mm	in.	mm	lbs.	kg
MP5161	4000	.75	19	1.9	49	7.0	178	3.4	1.5
MP5164	3000	.75	19	2.7	68	8.1	206	4.0	1.8
MP5168	3000	.75	19	2.7	68	8.1	206	9.0	4.1

**General:**  
 Air Inlet 1/4" NPT  
 Use 1/4" (6.4 mm) I.D. hose  
 All tools performance rated @ 90psi (620 kPa) air pressure.

**Standard Equipment:**  
 Models MP5161 & MP5164  
 5861600 Quick change spring  
 Owners manual  
 Parts sheet

**Model MP5168 Chisel Kit:**  
 MP5164 Power Chisel  
 5861600 Quick change spring  
 9253900 Undercoat scraper  
 9253500 Sheet metal cutter  
 9254000 Tapered punch  
 9254500 9" Flat Chisel  
 9254600 Chisel blank  
 Owners manual  
 Parts sheet



# Power Chisel

Accessories

Model Number	Description	Length		Point Size	
		in.	mm	in.	mm
<b>Rotating Chisel Bits for MP5161, MP5164 &amp; MP5163</b>					
<b>Standard .401" (70.79mm) diameter shank</b>					
9253500	Sheet Metal Cutter	6.0	152	3/4	19
9253600	Panel Cutter	6.0	152	5/8	16
9253900	Undercoat Scraper	7.5	191	1 5/32	29
9254000	Tapered Punch	6.0	152	1/8 Dia.	3.2
9254200	Spot Weld Breaker	7.0	178	1 5/16	33
9254300	Nut & Bolt Cutter	4.5	114	3/4	19
9254500	Nut & Bolt Cutter	9.0	203	3/4	19
9254600	Chisel Blank	6.0	152	1/2	13
80103100	2" Non Spark	7.5	190.5	2	50.8

**(Non-Rotating) Bits for MP5161, MP5164 & MP5168**  
**Standard .401" (70.79mm) diameter shank**

51653†	Panel Cutter	6.0	152	3/4	19
51654†	Ripper	6.5	165	5/8	16
51656†	Panel Cutter	7.0	178	15/16	24
51657†	Taper Punch	7.0	178	1/8 Dia.	3.2

† Quotation required.



9253500, (51656)



9253600, (51654)



9253900



9254000, (51657)



9254200



9254300



9254500



9254600



80103100



(51653)

CUTTING & PERCUSSION



## Collets



Part Number	Collet Size	Capacity	
		Min.	Max.
<b>Series 200 Collets</b>			
70497700	1/8"	3/32"	1/8"
70497800	1/4"	7/32"	1/4"
70497900	3/16"	5/32"	3/16"
70498000	7/32"	3/16"	7/32"
70498400	5/16"	9/32"	5/16"
70498600	3/8"	11/32"	3/8"
<b>Series 300 Collets</b>			
70498100	1/8"	3/32"	1/8"
70498200	1/4"	7/32"	1/4"
70498300	3/16"	5/32"	3/16"



## Jacobs® Chucks

Model Number			Thread Size	Capacity	Description
Chuck Only	Key Only	Chuck & Key			
-	-	-	-	-	No Chuck
-	770501	90013500	3/8"-24	1/4"	1 BA
9112301	770501	-	3/8"-24	1/4" Heavy Duty	7 BA
70194901	613301	14502	3/8"-24	3/8"	41 BA
80046800	479401	-	3/8"-24	1/2"	33 BA
80110000	80110100	-	3/8"-24	1/2"	Multi-Craft®

## Air Hoses

Part Number	Description
63594	3/8"x3/8"x8' Rubber Hose
63596	1/4"x1/4"x8' Braided Hose, non swivel
70488400	1/4"x1/4"x8' Braided Hose, swivel ends



63594



63596

## Grease



**513156**  
16 oz. can

**543944**  
16 oz. can for MP4424



**540395**  
2 oz. tube



**70497600**  
Grease dispenser  
(order grease separately)

## Master Guard Air Oil



**60538** 4 oz.



**60539** 1 quart





# The Total Solution

The total solution from Cooper Power Tools includes not only a complete line of quality industrial tools and accessories but also a professional engineering and product support staff to help customize each tool to specific application requirements. All are as close as a telephone or e-mail.

Cooper Power Tools maintains company-owned Service Centers in strategic locations throughout the world, staffed with professional tool repair technicians who use genuine Cooper Power Tools parts and who are outfitted with the very latest in testing, calibration and inspection equipment. Each tool that is returned



to a customer from one of our Service Centers carries with it a warranty that is Cooper Power Tools' assurance that it will perform just like it did when it was purchased new.

Our support personnel are fully capable of helping to diagnose problems and promptly recommend solutions.

Our complete line of tools are carefully designed and built from the finest materials available in order to pro-

vide years of trouble free service. But, as with any piece of equipment, service problems can occur. All tools are designed to be easy to service ... that is, of course, with properly trained personnel.

To facilitate quick repairs, and limit downtime ... Cooper Power Tools conducts training seminars covering all aspects of every tool we make.

## TRAINING

Introductory training seminars are designed to fully acquaint students with the entire line of tools and their fundamental operation. Advanced training seminars, which are often tailored to individual needs, are designed to hone the skills of the experienced student. Hands-on experience, with an emphasis on troubleshooting and repairing, are the focus of this training.

Service literature, product information, brand catalogs and FAQs are also available around the clock on the Web. Just access [www.cooperpowertools.com](http://www.cooperpowertools.com) for the latest information available about any of our products and services.







# Conversion Tables

Millimeter – Decimal – Fraction

mm	Dec.	in.	mm	Dec.	in.	mm	Dec.	in.	mm	Dec.	in.	mm	Dec.	in.
0.100	.0039		<b>5.159</b>	<b>.2031</b>	<b>13/64</b>	10.200	.4016		15.300	.6024		20.300	.7992	
0.200	.0079		5.200	.2047		10.300	.4055		15.400	.6063		20.400	.8031	
0.300	.0118		5.300	.2087		<b>10.319</b>	<b>.4063</b>	<b>13/32</b>	<b>15.478</b>	<b>.6094</b>	<b>39/64</b>	20.500	.8071	
<b>0.397</b>	<b>.0156</b>	<b>1/64</b>	5.400	.2126		10.400	.4094		15.500	.6102		20.600	.8110	
0.400	.0157		5.500	.2165		10.500	.4134		15.600	.6142		<b>20.638</b>	<b>.8125</b>	<b>13/16</b>
0.500	.0197		<b>5.556</b>	<b>.2188</b>	<b>7/32</b>	10.600	.4173		15.700	.6181		20.700	.8150	
0.600	.0236		5.600	.2205		10.700	.4219		15.800	.6220		20.800	.8189	
0.700	.0276		5.700	.2244		<b>10.716</b>	<b>.4219</b>	<b>27/64</b>	<b>15.875</b>	<b>.6250</b>	<b>5/8</b>	20.900	.8228	
<b>0.794</b>	<b>.0313</b>	<b>1/32</b>	5.800	.2283		10.800	.4252		15.900	.6250		21.000	.8268	
0.800	.0315		5.900	.2323		10.900	.4291		16.000	.6299		<b>21.034</b>	<b>.8182</b>	<b>53/64</b>
0.900	.0354		<b>5.953</b>	<b>.2344</b>	<b>15/64</b>	11.000	.4331		16.100	.6339		21.100	.8307	
1.000	.0394		6.000	.2362		11.100	.4370		16.200	.6378		21.200	.8307	
1.100	.0433		6.100	.2402		<b>11.113</b>	<b>.4375</b>	<b>7/16</b>	<b>16.272</b>	<b>.6406</b>	<b>41/64</b>	21.200	.8346	
<b>1.191</b>	<b>.0469</b>	<b>3/64</b>	6.200	.2441		11.200	.4409		16.300	.6417		21.300	.8386	
1.200	.0472		6.300	.2480		11.300	.4449		16.400	.6457		21.400	.8425	
1.300	.0512		<b>6.350</b>	<b>.2500</b>	<b>1/4</b>	11.400	.4488		16.500	.6496		<b>21.431</b>	<b>.8438</b>	<b>27/32</b>
1.400	.0551		6.400	.2520		11.500	.4528		16.600	.6535		21.500	.8465	
1.500	.0591		6.500	.2559		<b>11.509</b>	<b>.4531</b>	<b>29/64</b>	<b>16.669</b>	<b>.6563</b>	<b>21/32</b>	21.600	.8504	
<b>1.588</b>	<b>.0625</b>	<b>1/16</b>	6.600	.2598		11.600	.4567		16.700	.6575		21.700	.8543	
1.600	.0630		6.700	.2638		11.700	.4606		16.800	.6614		21.800	.8583	
1.700	.0669		<b>6.747</b>	<b>.2656</b>	<b>17/64</b>	11.800	.4646		16.900	.6654		<b>21.828</b>	<b>.8594</b>	<b>55/94</b>
1.800	.0709		6.800	.2677		11.900	.4685		17.000	.6693		21.900	.8622	
1.900	.0748		6.900	.2717		<b>11.906</b>	<b>.4688</b>	<b>15/32</b>	<b>17.066</b>	<b>.6719</b>	<b>43/64</b>	22.000	.8661	
<b>1.984</b>	<b>.0781</b>	<b>5/64</b>	7.000	.2756		12.000	.4724		17.100	.6732		22.100	.8701	
2.000	.0787		7.100	.2795		12.100	.4764		17.200	.6772		22.200	.8740	
2.100	.0827		<b>7.144</b>	<b>.2813</b>	<b>9/32</b>	12.200	.4803		17.300	.6811		<b>22.225</b>	<b>.8750</b>	<b>7/8</b>
2.200	.0866		7.200	.2835		12.300	.4843		17.400	.6850		22.300	.8780	
2.300	.0906		7.300	.2874		<b>12.303</b>	<b>.4844</b>	<b>31/64</b>	<b>17.463</b>	<b>.6875</b>	<b>11/16</b>	22.400	.8819	
<b>2.381</b>	<b>.0938</b>	<b>3/32</b>	7.400	.2913		12.400	.4882		17.500	.6890		22.500	.8858	
2.400	.0945		7.500	.2953		12.500	.4921		17.600	.6929		22.600	.8898	
2.500	.0984		<b>7.541</b>	<b>.2969</b>	<b>19/64</b>	12.600	.4961		17.700	.6968		<b>22.622</b>	<b>.8906</b>	<b>57/64</b>
2.600	.1024		7.600	.2992		<b>12.700</b>	<b>.5000</b>	<b>1/2</b>	17.800	.7008		22.700	.8937	
2.700	.1063		7.700	.3031		12.800	.5039		<b>17.859</b>	<b>.7031</b>	<b>45/64</b>	22.800	.8976	
<b>2.778</b>	<b>.1094</b>	<b>7/64</b>	7.800	.3071		12.900	.5079		17.900	.7047		22.900	.9016	
2.800	.1102		7.900	.3110		13.000	.5118		18.000	.7087		23.000	.9055	
2.900	.1142		<b>7.938</b>	<b>.3125</b>	<b>5/16</b>	<b>13.097</b>	<b>.5156</b>	<b>33/64</b>	18.100	.7126		<b>23.019</b>	<b>.9063</b>	<b>29/32</b>
3.000	.1181		8.000	.3150		13.100	.5157		18.200	.7165		23.100	.9094	
3.100	.1220		8.100	.3189		13.200	.5197		<b>18.256</b>	<b>.7188</b>	<b>23/32</b>	23.200	.9134	
<b>3.175</b>	<b>.1250</b>	<b>1/8</b>	8.200	.3228		13.300	.5236		18.300	.7205		23.300	.9173	
3.200	.1260		8.300	.3268		13.400	.5276		18.400	.7244		23.400	.9213	
3.300	.1299		<b>8.334</b>	<b>.3281</b>	<b>21/64</b>	<b>13.494</b>	<b>.5313</b>	<b>17/32</b>	18.500	.7283		<b>23.416</b>	<b>.9219</b>	<b>59/64</b>
3.400	.1339		8.400	.3307		13.500	.5315		18.600	.7323		23.500	.9252	
3.500	.1378		8.500	.3346		13.600	.5354		<b>18.653</b>	<b>.7344</b>	<b>47/64</b>	23.600	.9291	
<b>3.572</b>	<b>.1406</b>	<b>9/64</b>	8.600	.3386		13.700	.5394		18.700	.7362		23.700	.9331	
3.600	.1417		8.700	.3425		13.800	.5433		18.800	.7402		23.800	.9370	
3.700	.1457		<b>8.731</b>	<b>.3438</b>	<b>11/32</b>	<b>13.891</b>	<b>.5469</b>	<b>35/64</b>	18.900	.7441		23.900	.9409	
3.800	.1496		8.800	.3465		13.900	.5472		19.000	.7480		24.000	.9449	
3.900	.1535		8.900	.3504		14.000	.5512		<b>19.050</b>	<b>.7500</b>	<b>3/4</b>	24.100	.9488	
<b>3.969</b>	<b>.1563</b>	<b>5/32</b>	9.000	.3543		14.100	.5551		19.100	.7520		24.200	.9528	
4.000	.1575		9.100	.3583		14.200	.5591		19.200	.7559		<b>24.209</b>	<b>.9531</b>	<b>61/64</b>
4.100	.1624		<b>9.128</b>	<b>.3594</b>	<b>23/64</b>	<b>14.288</b>	<b>.5625</b>	<b>9/16</b>	19.300	.7598		24.300	.9567	
4.200	.1654		9.200	.3622		14.300	.5630		19.400	.7638		24.400	.9606	
4.300	.1693		9.300	.3661		14.400	.5669		<b>19.447</b>	<b>.7656</b>	<b>49/64</b>	24.500	.9646	
<b>4.366</b>	<b>.1719</b>	<b>11/64</b>	9.400	.3701		14.500	.5709		19.500	.7677		24.600	.9685	
4.400	.732		9.500	.3740		14.600	.5748		19.600	.7717		<b>24.606</b>	<b>.9688</b>	<b>31/32</b>
4.500	.1772		<b>9.525</b>	<b>.3750</b>	<b>3/8</b>	<b>14.684</b>	<b>.5781</b>	<b>37/64</b>	19.700	.7756		24.700	.9724	
4.600	.1811		9.600	.3780		14.700	.5787		19.800	.7795		24.800	.9764	
4.700	.1850		9.700	.3819		14.800	.5827		<b>19.844</b>	<b>.7813</b>	<b>25/32</b>	24.900	.9803	
<b>4.763</b>	<b>.1875</b>	<b>3/16</b>	9.800	.3858		14.900	.5866		19.900	.7835		25.000	.9843	
4.800	.1890		9.900	.3898		15.000	.5906		20.000	.7874		<b>25.003</b>	<b>.9844</b>	<b>63/64</b>
4.900	.1929		<b>9.922</b>	<b>.3902</b>	<b>25/64</b>	<b>15.081</b>	<b>.5938</b>	<b>19/32</b>	20.100	.7913		25.100	.9882	
5.000	.1969		10.000	.3937		15.100	.5945		20.200	.7953		25.200	.9921	
5.100	.2008		10.100	.3976		15.200	.5984		<b>20.241</b>	<b>.7969</b>	<b>51/64</b>	25.300	.9961	
												<b>25.400</b>	<b>1.000</b>	<b>1</b>



# Conversion Tables

Torque – Air Pressure – Miscellaneous



Torque Conversion – In. Lbs. (Nm)					
In.	Nm	In.	Nm	In.	Nm
5	0.6	50	5.7	140	15.8
10	1.1	60	6.8	150	17.0
15	1.7	70	7.9	160	18.1
20	2.3	80	9.0	170	19.2
25	2.8	90	10.2	180	20.3
30	3.4	100	11.3	190	21.5
35	4.0	110	12.4	200	22.6
40	4.5	120	13.6		
45	5.1	130	14.7		

Torque Conversion – Ft. Lbs. (Nm)					
Ft. Lbs.	Nm	Ft. Lbs.	Nm	Ft. Lbs.	Nm
1	1.36	43	58.3	85	115.3
2	2.7	44	60.0	86	117.0
3	4.1	45	61.0	87	118.0
4	5.4	46	62.4	88	119.3
5	6.8	47	63.7	89	121.0
6	8.1	48	65.1	90	122.0
7	9.5	49	66.4	91	123.4
8	10.9	50	67.8	92	125.0
9	12.2	51	69.2	93	126.1
10	13.6	52	70.5	94	127.5
11	14.9	53	71.9	95	129.0
12	16.3	54	73.2	96	130.2
13	17.6	55	74.6	97	131.5
14	19.0	56	75.9	98	133.0
15	20.3	57	77.3	99	134.2
16	21.7	58	78.7	100	135.6
17	23.1	59	80.0	110	149.2
18	24.4	60	81.4	115	156.0
19	25.8	61	82.7	120	163.0
20	27.1	62	84.1	125	170.0
21	28.5	63	85.4	130	176.3
22	29.8	64	86.8	135	183.1
23	31.2	65	88.1	140	190.0
24	32.5	66	90.0	145	197.0
25	33.9	67	90.9	150	203.4
26	35.3	68	92.2	155	210.2
27	36.6	69	93.6	160	217.0
28	38.0	70	94.9	165	224.0
29	39.3	71	96.3	170	231.0
30	40.7	72	97.6	175	237.3
31	42.0	73	99.0	180	244.1
32	43.4	74	100.3	185	251.0
33	44.8	75	102.0	190	258.0
34	46.1	76	103.1	195	264.4
35	47.5	77	104.4	200	271.2
36	48.8	78	105.8	225	305.1
37	50.2	79	107.1	250	339.0
38	52.0	80	108.5	275	373.0
39	52.9	81	110.0	300	407.0
40	54.2	82	111.2	350	475.0
41	55.6	83	112.6	400	542.4
42	57.0	84	114.0		

Torque Conversion factors		
To Convert	Into	Multiply By
Inch Pounds	Foot Pounds	0.0835
Inch Pounds	Newton meters	0.1130
Inch Pounds	Kg-meters	0.0115
Inch Pounds	Kg-Cm	1.1519
Foot Pounds	Inch Pounds	12.000
Foot Pounds	Newton meters	1.3560
Foot Pounds	Kg-meters	0.1382
Foot Pounds	Kg-Cm	13.8240
Newton Meters	Inch Pounds	8.8440
Newton Meters	Foot Pounds	0.7370
Newton Meters	Kg-meters	0.1020
Newton Meters	Kg-Cm	10.2000
Kg meters	Inch Pounds	86.8100
Kg meters	Foot Pounds	7.2340
Kg meters	Newton-meters	9.8040
Kg Cm	Inch Pounds	0.8681
Kg Cm	Foot Pounds	0.0723
Kg Cm	Newton-meters	0.0980

Miscellaneous Conversion Factors		
To Convert	Into	Multiply By
Inches	Millimeters	25.4000
Millimeters	Inches	0.0394
Pounds	Kilograms	0.4536
Kilograms	Pounds	2.2050
psi	bar	0.069
bar	psi	14.5

Air Pressure Conversion		
PSI	kPa*	Bar**
85	586	5.9
90	620	6.2
95	655	6.6
100	690	6.9
125	860	8.6

\* Preferred: Approximate to the nearest 5 kPa.  
 \*\* Approximate to the nearest 0.5 Bar.

# Sales & Service Centers

**Note:** All locations may not service all products. Please contact the nearest Sales & Service Center for the appropriate facility to handle your service requirements.

## Dallas, TX

### **Cooper Power Tools Sales & Service Center**

1470 Post & Paddock  
Grand Prairie, TX 75050  
Tel: (972) 641-9563  
Fax: (972) 641-9674

## Detroit, MI

### **Cooper Power Tools Sales & Service Center**

4121 North Atlantic Blvd.  
Auburn Hills, MI 48326  
Tel: (248) 391-3700  
Fax: (248) 391-6295

## Houston, TX

### **Cooper Power Tools Sales & Service Center**

6550 West Sam Houston  
Parkway North, Suite 200  
Houston, TX 77041  
Tel: (713) 849-2364  
Fax: (713) 849-2047

## Seattle, WA

### **Cooper Power Tools Sales & Service Center**

2865 152nd Ave N.E.  
Redmond, WA 98052  
Tel: (425) 497-0476  
Fax: (425) 497-0496

## Lexington, SC

### **Cooper Power Tools**

670 Industrial Drive  
Lexington, SC 29072  
Tel: (800) 845-5629  
Tel: (803) 951-7544  
Fax: (803) 358-7681

## York, PA

### **Cooper Power Tools Sales & Service Center**

York Service Center  
3990 E. Market Street  
York, PA 17402  
Tel: (717) 755-2933  
Fax: (717) 757-5063

## Brazil

### **Cooper Tools Industrial Ltda.**

Av. Liberdade, 4055  
Zona Industrial - Iporanga  
18087-170 Sorocaba, SP Brazil  
Tel: (011) 55 15 238 3929  
Fax: (011) 55 15 228 3260

## Canada

### **Cooper Power Tools Sales & Service Center**

5925 McLaughlin Road  
Mississauga, Ont. L5R 1B8  
Canada  
Tel: (905) 501-4785  
Fax: (905) 501-4786

## China

### **Cooper (China) Co., Ltd.**

955 Sheng Li Road,  
Heqing Pudong, Shanghai  
China 201201  
Tel: +86-21-28994176  
Fax: + 86-21-51118446

## France

### **Cooper Power Tools SAS Recoules Operation**

Zone Industrielle  
BP 28  
Avenue Maurice Chevalier  
77831 Ozoir-la-Ferrière Cedex  
France  
Tel: (011) 33 1 64 43 22 00  
Fax: (011) 33 1 64 40 17 17

## Germany

### **Cooper Power Tools GmbH & Co. OHG**

Postfach 30  
D-73461 Westhausen  
Tel: +49 (0) 73 63/ 81-0  
Fax: +49 (0) 73 63/ 81-222

## Mexico

### **Cooper Power Tools de México S.A. de C.V.**

Libramiento La Joya No. 1  
Bodega No. 2  
Esq. Politécnico, Barrio San José  
Cuautitlán, Edo de México C.P. 54870  
Phone: (011) 525 5899 9510  
Fax: (011) 525 5870 5012

## Cooper Power Tools Is On The Web!

Cooper Power Tools provides a complete resource for power tools on-line. Our website [www.cooperpowertools.com](http://www.cooperpowertools.com) offers product information, service literature, brand catalogs, press releases and more. A dominant source of information, the Cooper Power Tools website is your source for application solutions on-line.



## Making your job easier is our goal!

You can access service literature anytime. Choose a category such as Assembly Tools or Material Removal Tools from the main menu and then click on the brand you're looking for. You'll be on your way to any current service literature you need, whether it's Cleco, Apex, Master Power, or any of our power tool brands.

Up-to-date product catalogs are also available online providing

you with current information on our broad product line. Even Material Safety Data Sheets (M.S.D.S.) for Safety and Disposal Information are available on our website.



## It's simple!

Our *Customer Care* section provides you with information such as answers to frequently asked questions or contact phone numbers and addresses for your area of the country. You can browse through the *What's New* information to learn how Cooper Power Tools continues to be your source for solutions.

For even faster searches, you can go direct to a brand site by simply entering the brand name. Entering [www.dotco-tools.com](http://www.dotco-tools.com) takes you directly to the Dotco brand site.

What is the future of [www.cooperpowertools.com](http://www.cooperpowertools.com)? A dynamic site continuing to focus on your need for up-to-date information on the latest Cooper Power Tools' offerings that you can access anytime you need... twenty-four hours a day, seven days a week!



## Sales & Service Centers

**Note:** All locations may not service all products. Please contact the nearest Sales & Service Center for the appropriate facility to handle your service requirements.

**Dallas, TX**  
**Cooper Power Tools**  
**Sales & Service Center**  
1470 Post & Paddock  
Grand Prairie, TX 75050  
Tel: (972) 641-9563  
Fax: (972) 641-9674

**Detroit, MI**  
**Cooper Power Tools**  
**Sales & Service Center**  
4121 North Atlantic Blvd.  
Auburn Hills, MI 48326  
Tel: (248) 391-3700  
Fax: (248) 391-6295

**Houston, TX**  
**Cooper Power Tools**  
**Sales & Service Center**  
6550 West Sam Houston  
Parkway North, Suite 200  
Houston, TX 77041  
Tel: (713) 849-2364  
Fax: (713) 849-2047

**Lexington, SC**  
**Cooper Power Tools**  
670 Industrial Drive  
Lexington, SC 29072  
Tel: (800) 845-5629  
Tel: (803) 359-1200  
Fax: (803) 358-7681

**Seattle, WA**  
**Cooper Power Tools**  
**Sales & Service Center**  
2865 152nd Ave N.E.  
Redmond, WA 98052  
Tel: (425) 497-0476  
Fax: (425) 497-0496

**York, PA**  
**Cooper Power Tools**  
**Sales & Service Center**  
3990 East Market Street  
York, PA 17402  
Tel: (717) 755-2933  
Fax: (717) 757-5063

**Canada**  
**Cooper Power Tools**  
**Sales & Service Center**  
5925 McLaughlin Road  
Mississauga, Ont. L5R 1B8  
Canada  
Tel: (905) 501-4785  
Fax: (905) 501-4786

**Cooper Power Tools**  
P.O. Box 1410  
Lexington, SC 29071-1410  
USA  
Phone: 800-845-5629  
803-359-1200  
Fax: 803-359-0822

**Cooper Power Tools**  
4121 North Atlantic Blvd.  
Auburn Hills, MI 48326  
USA  
Phone: (248) 391-3700  
Fax: (248) 391-6295

**Cooper Power Tools**  
5925 McLaughlin Road  
Mississauga, Ontario  
Canada L5R 1B8  
Phone: (905) 501-4785  
Fax: (905) 501-4786

**Cooper Power Tools**  
**de México S.A. de C.V.**  
Libramiento La Joya No. 1  
Bodega No. 2  
Esq. Politécnico  
Barrio San José  
Cuautitlán, Edo de México  
C.P. 54870  
Phone: +52-55-5899-9510  
Fax: +52-55-5870-5012

**Cooper Tools Industrial Ltda.**  
Av. Liberdade, 4055  
Zona Industrial - Iporanga  
18087-170 Sorocaba, SP  
Brazil  
Tel: +55-15-3238-3929  
Fax: +55-15-228-3260

**Cooper Power Tools SAS**  
Zone industrielle - B.P. 28  
77831 Ozoir-la-Ferrière Cedex  
France  
Téléphone: +33-1-6443-2200  
Téléfax: +33-1-6440-1717

**Cooper Power Tools**  
**GmbH & Co. OHG**  
Postfach 30  
D-73461 Westhausen  
Germany  
Phone: +49 (0) 73 63/ 81-0  
Fax: +49 (0) 73 63/ 81-222  
E-Mail:  
htwe.sales@cooperindustries.com

**Cooper Tools Hungária Kft.**  
Berkenyefa sor 7  
H-9027 Győr  
Hungary  
Tel: +36-96-505 300  
Fax: +36-96-505 301

**Cooper (China) Co., Ltd.**  
955 Sheng Li Road,  
Heqing Pudong, Shanghai  
China 201201  
Tel: +86-21-28994176  
+86-21-28994177  
Fax: +86-21-51118446

[www.cooperpowertools.com](http://www.cooperpowertools.com)

**Cooper Industries, Ltd.**  
600 Travis, Ste. 5800  
Houston, TX 77002-1001  
P: 713-209-8400  
[www.cooperindustries.com](http://www.cooperindustries.com)